

Input data

| | | |
|-----------------------|-------|-----------------------------|
| System of measurement | | Metric |
| Input type | | Coupling for electric motor |
| Input speed | [rpm] | 1400 |
| Output speed | [rpm] | 93.33 |
| Ratio (i=) | | 15 |
| Frequency | [Hz] | 50 |
| Input options | | IEC |
| Requested input power | [kW] | 2.2 |
| Service factor | | 1 |
| Rated Power P1 | [kW] | 2.21 |

Output data

| | |
|------------------|-----------------------------------|
| Gear unit | F RT 70 B3 15 100 B5 AC 30 |
|------------------|-----------------------------------|

| | | |
|---------------------|---------------------|--------------------------|
| Type | | RT - Worm speed reducers |
| Input type | | F (Elastic coupling) |
| Size | | 70 |
| Ratio (i=) | | 15 |
| Input flange | | B5 |
| Input speed | [rpm] | 1400 |
| Output speed | [rpm] | 93.33 |
| Rated output torque | [Nm] | 186.84 |
| Service Factor | | 1 |
| Efficiency | | 0.83 |
| Inertia moment | [kgm ²] | 0.000257 |

Gear unit configuration

| | | |
|--------------|--|---------------------|
| Output shaft | | Hollow output shaft |
| Fixing | | Universal |
| Version | | B3 |

Output radial and axial loads

| | | |
|-----------------------------------|-----|------|
| Ball bearings output radial load | [N] | 3600 |
| Taper bearings output radial load | [N] | 4500 |
| Ball bearings output axial load | [N] | 720 |
| Taper bearings output axial load | [N] | 900 |

Accessories

| | | |
|---------------------|--|-------|
| Hollow output shaft | | AC 30 |
|---------------------|--|-------|

Electric motor coupling

| | | |
|----------|------|--------|
| Size | | 100 A4 |
| Poles n. | | 4 |
| Power | [kW] | 2.2 |

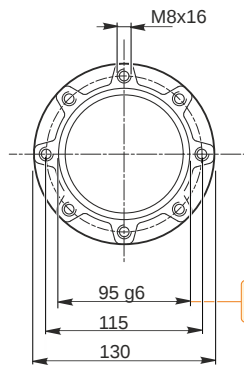
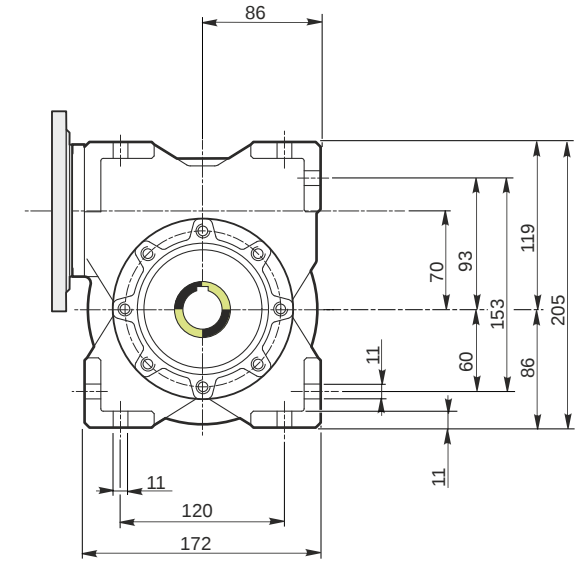
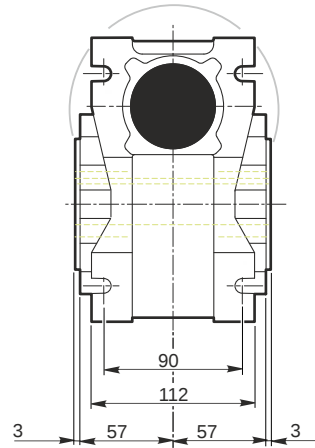
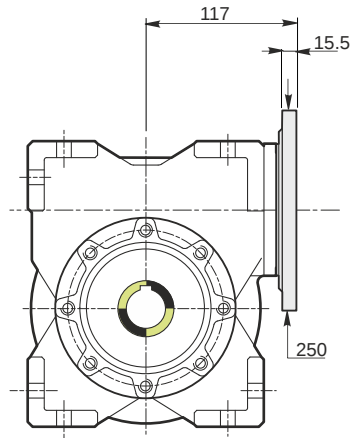

Hollow output shaft

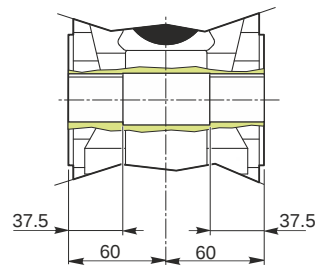
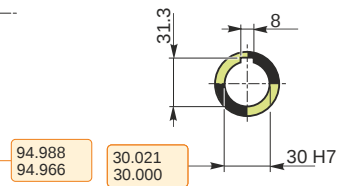

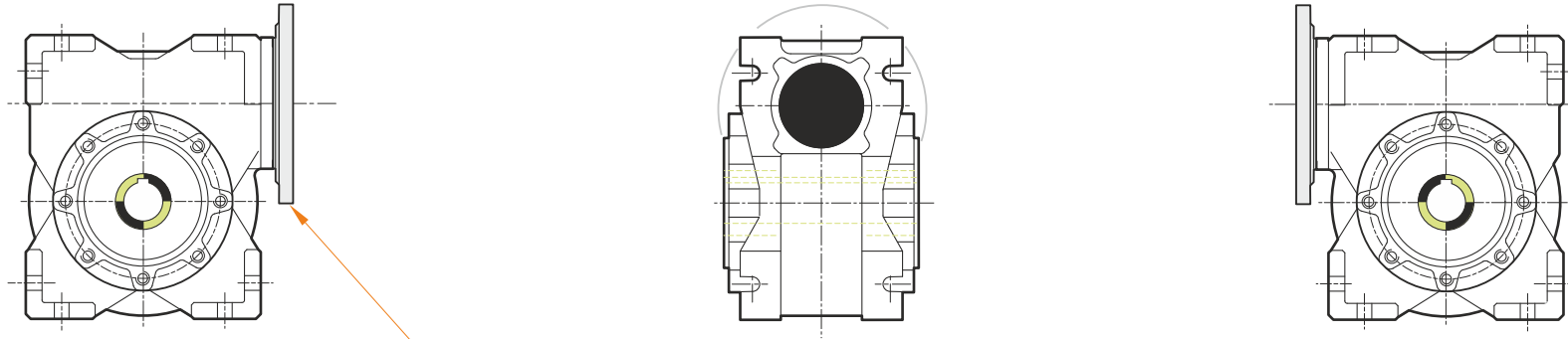

This gear unit is provided with an elastic coupling motor fitting

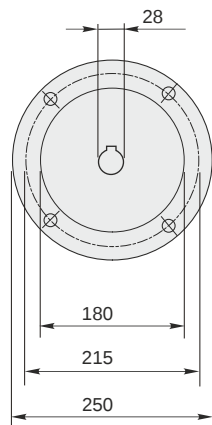

Mounting positions

B3

B6

B7

B8

V5

V6

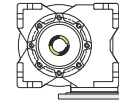
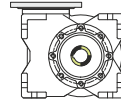
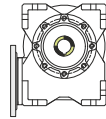
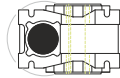
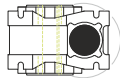
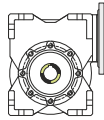

0.35



← Oil quantity [litres]

Lubricant type: Long life synthetic oil ISO VG320

Direction of rotation

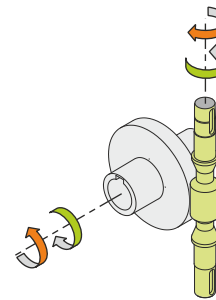
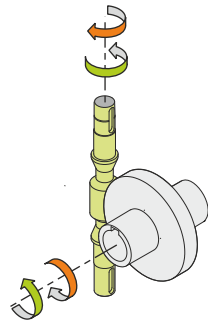
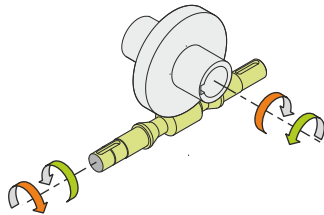

Weight

Gear unit [kg] 9

Gearing data

| | |
|------------------|---------|
| Axial module | 3.6 |
| Number of starts | 2 |
| Lead angle | 12° 40' |
| Pressure angle | 20° |

Backdriving

Static back-driving
Quick back-driving
Dynamic back-driving