

Input data

| | | |
|-----------------------|-------|-----------------------------|
| System of measurement | | Metric |
| Input type | | Coupling for electric motor |
| Input speed | [rpm] | 1400 |
| Output speed | [rpm] | 93.33 |
| Ratio (i=) | | 15 |
| Frequency | [Hz] | 50 |
| Input options | | IEC |
| Requested input power | [kW] | 1.1 |
| Service factor | | 5.9 |
| Rated Power P1 | [kW] | 6.52 |

Output data

| | |
|------------------|-----------------------------------|
| Gear unit | F RT 110 B3 15 90 B5 AC 42 |
|------------------|-----------------------------------|

| | | |
|---------------------|---------------------|--------------------------|
| Type | | RT - Worm speed reducers |
| Input type | | F |
| Size | | 110 |
| Ratio (i=) | | 15 |
| Input flange | | B5 |
| Input speed | [rpm] | 1400 |
| Output speed | [rpm] | 93.33 |
| Rated output torque | [Nm] | 94.54 |
| Service Factor | | 5.9 |
| Efficiency | | 0.84 |
| Inertia moment | [kgm ²] | 0.001796 |

Gear unit configuration

| | | |
|--------------|--|---------------------|
| Output shaft | | Hollow output shaft |
| Fixing | | Universal |
| Version | | B3 |

Output radial and axial loads

| | | |
|-----------------------------------|-----|------|
| Ball bearings output radial load | [N] | 5200 |
| Taper bearings output radial load | [N] | 6700 |
| Ball bearings output axial load | [N] | 1040 |
| Taper bearings output axial load | [N] | 1340 |

Accessories

| | | |
|---------------------|--|-------|
| Hollow output shaft | | AC 42 |
|---------------------|--|-------|

Electric motor coupling

| | | |
|----------|------|-------|
| Size | | 90 S4 |
| Poles n. | | 4 |
| Power | [kW] | 1.1 |

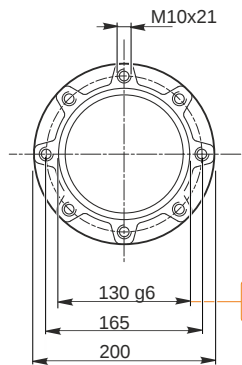
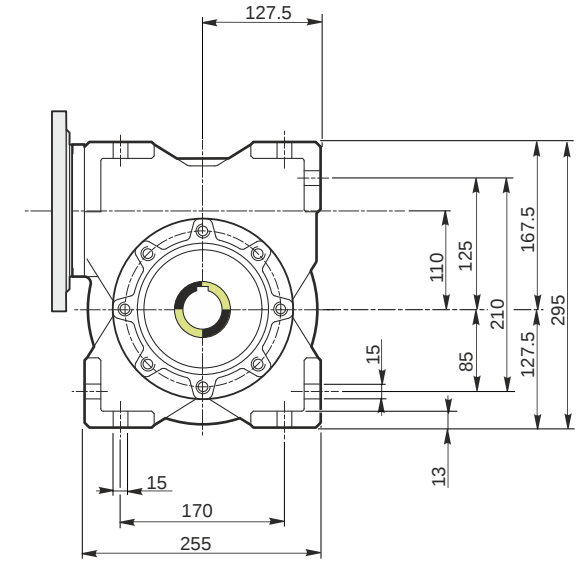
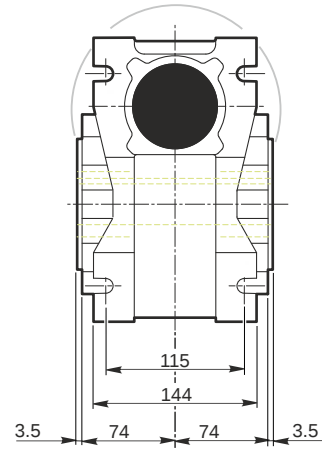
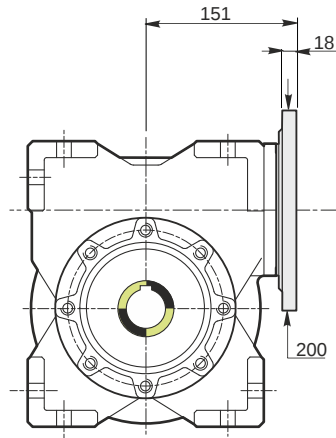

Hollow output shaft

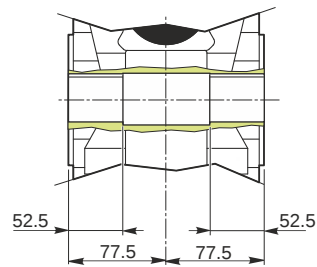
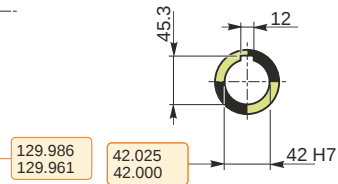

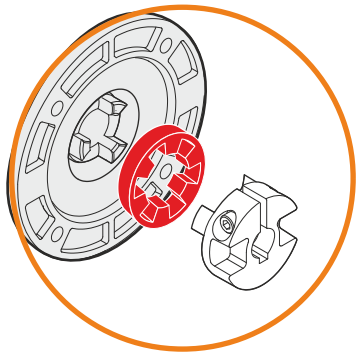
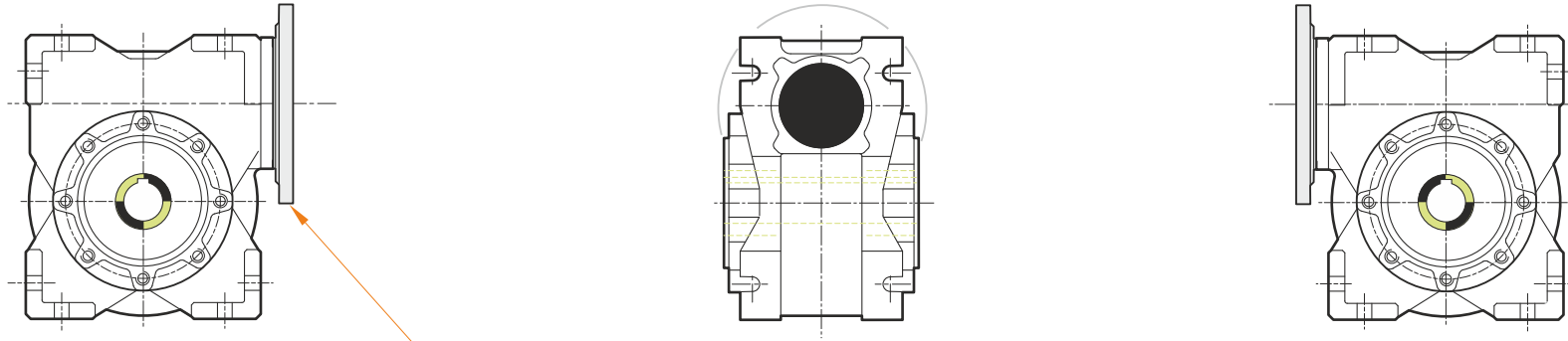

This gear unit is provided with an elastic coupling motor fitting

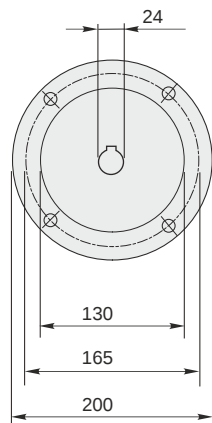

Mounting positions

B3

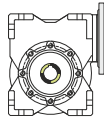

B6

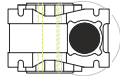

B7

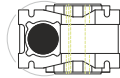

B8

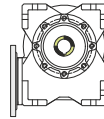

V5

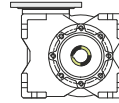

V6

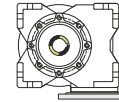

1.5



← Oil quantity [litres]

Lubricant type: Long life synthetic oil ISO VG320

Direction of rotation

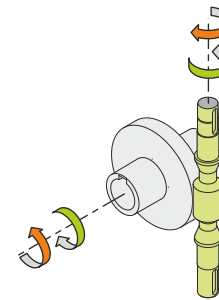
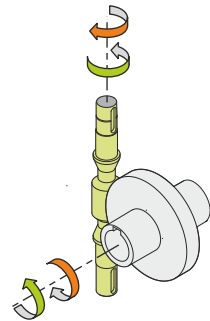
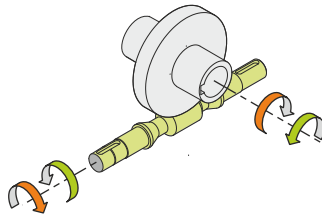
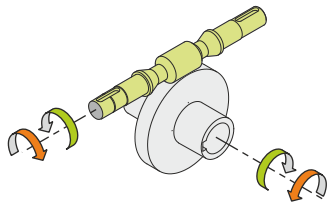

Weight

Gear unit [kg] 39

Gearing data

Axial module 5.8
 Number of starts 2
 Lead angle 14° 09'
 Pressure angle 20°

Backdriving

Static back-driving
 Quick back-driving
 Dynamic back-driving